

Condensate discharge by peristaltic pumps

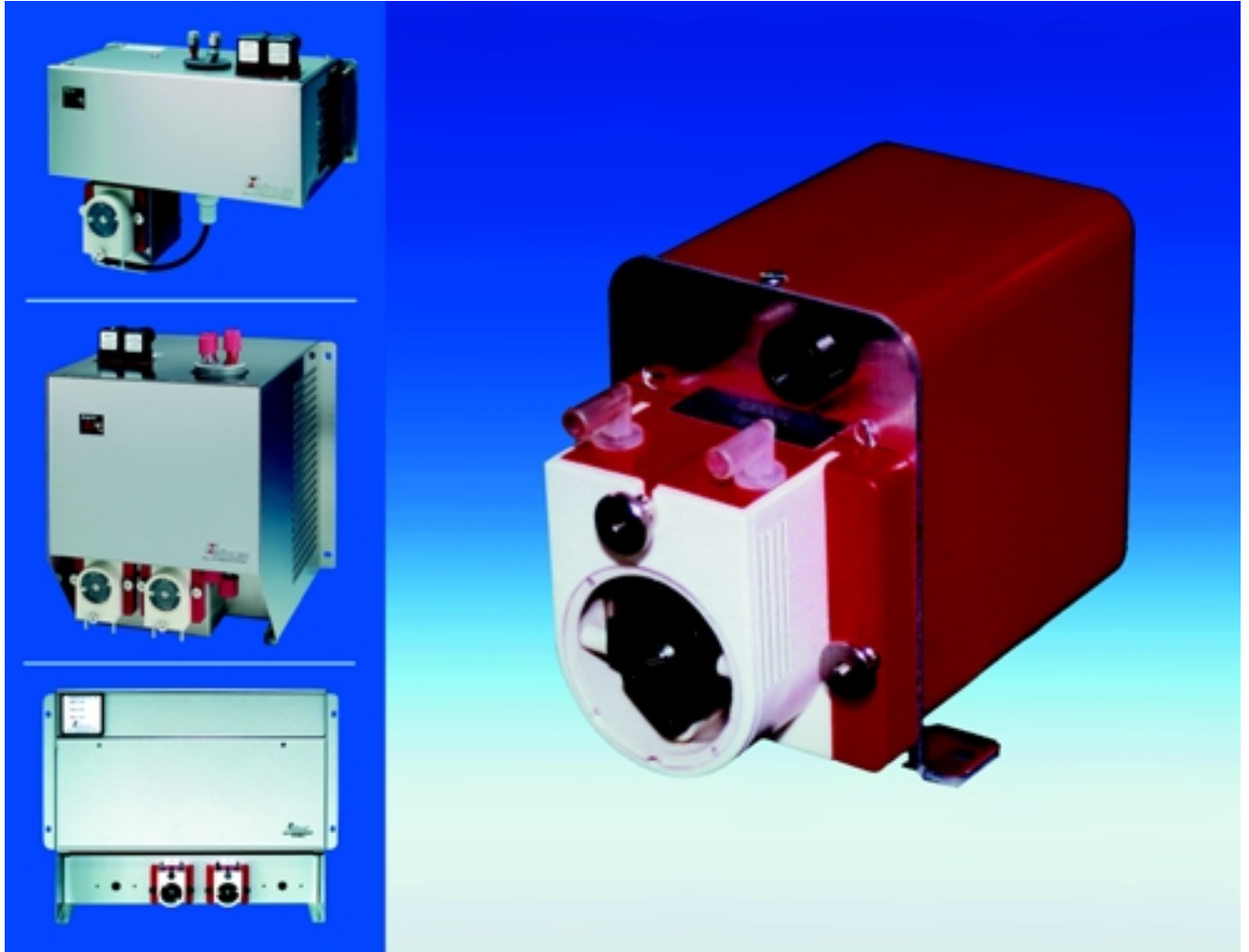

The discharge of condensate from sample conditioning systems requires special discharge systems.

Peristaltic pumps are the appropriate equipment for systems operating at pressure below ambient.

To make integration as simple as possible, we provide add-on frames which are mounted directly to the EGK 1/2 or EGK 4 compressor coolers. Up to 2 pumps can be integrated inside the EGK 1/2 and up to 4 inside the EGK 4 frame.

For other applications standalone pumps with protection housing are available.

Peltier coolers PKE 4 can be delivered with a pump already mounted.

technical data peristaltic pump

power supply	230 V AC, 50/60 Hz	115 V AC, 50/60 Hz
power consumption	60 mA	110 mA
protection class	IP 51	IP 51
connection	flat plug	flat plug

suction volume	0,3 l/h
vaccum	> 320 mbar
pressure	> 0,5 bar
hose	3x1, Silicon

higher suction volume on request

please indicate with order

part no. **type**

pump

- 45 10 122 peristaltic pump with shield for stand alone installation 230 V AC, 50/60 Hz, protection class IP 51
- 45 10 222 peristaltic pump with shield for stand alone installation 115 V AC, 50/60 Hz, protection class IP 51

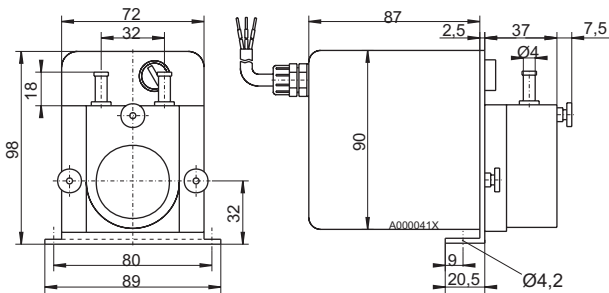

EGK 4

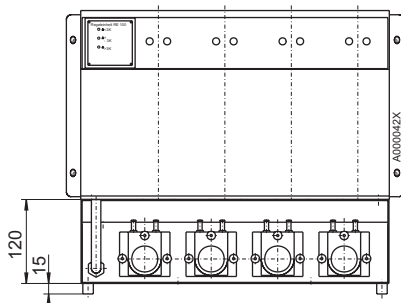

EGK 4

- 45 10 120 auxiliary frame for EGK 4 assembled with peristaltic pump 230 V AC, 50/60 Hz
- 45 10 220 auxiliary frame for EGK 4 assembled with peristaltic pump 115 V AC, 50/60 Hz
- 45 10 121 additional peristaltic pump 230 V AC, 50/60 Hz
- 45 10 221 additional peristaltic pump 115 V AC, 50/60 Hz

EGK 1/2

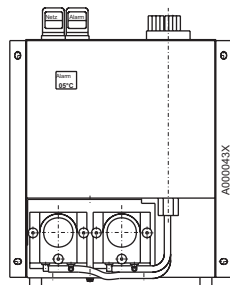

EGK 1/2

- 45 10 130 auxiliary frame for EGK 1/2 assembled with peristaltic pump 230 V AC, 50/60 Hz
- 45 10 131 auxiliary frame for EGK 1/2 assembled with peristaltic pump 115 V AC, 50/60 Hz
- 45 10 230 additional peristaltic pump 230 V AC, 50/60 Hz
- 45 10 231 additional peristaltic pump 115 V AC, 50/60 Hz

PKE 4

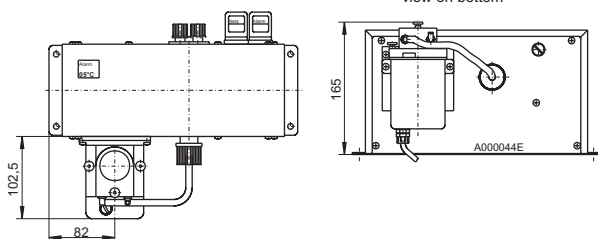

PKE 4

- 44 60 799 peristaltic pump assembled with PKE 4 230 V AC, 50/60 Hz
- 44 60 899 peristaltic pump assembled with PKE 4 115 V AC, 50/60 Hz